

12.1040

## DOLPHIN STRAIGHT GRAB BAR 400MM

- > Straight satin stainless steel grab bar:
- > Usage: Ideal for Disabled Toilets
- > Satin stainless steel finish

<b>DIAMETER</b>	<b>32 MM</b>
<b>WIDTH</b>	<b>400 MM</b>
<b>PROJECTION</b>	<b>92 MM</b>

### SPECIFICATION

Straight grab bar 400mm. Model number 12.1040 in satin finish stainless steel. Manufactured by Dolphin Solutions Ltd.

### MATERIAL

- > Bar: Ø32mm x 1.5mm tube with solid bar end plugs satin finish stainless steel grade 1.4301 (304)
- > Cover Plates: 1.2mm satin finish stainless steel grade 1.4301(304)
- > Legs: Ø25mm solid bar satin finish stainless steel grade 1.4301(304)
- > Wall Mounts: Aluminium 6082T6
- > Approximate unit weight: 1.9kg
- > Tested to 190kg BS EN 12182. Achievable weight load dependent on wall construction/fixings.

### PRODUCT CODES

- |         |         |
|---------|---------|
| > 600mm | 12.1060 |
| > 400mm | 12.1040 |

## INSTALLATION

- › See diagram opposite
- › Recommended mounting height from top surface of bar to FFL 680mm – Horizontal mounting
- › Unscrew covers (A) from wall mounts and slide covers away from mounts.
- › Mark location of fixing holes on wall
- › Drill holes and fix rail to wall using suitable countersunk screws
- › Slide covers back down leg on to wall mount
- › Screw covers on to wall mount

## CARE AND MAINTENANCE

- › Clean with soap and warm water; dry with a clean soft cloth.
- › To maintain finish use any industrial steel cleaner; polishing along the material grain with a clean soft cloth.
- › Abrasive cleaners, chloride cleaning agents and carbon steel brushes/steel wool will scratch the stainless steel and should not be used.

## WARRANTY

This product is covered by a 12-month warranty from the date of purchase to be free from defects if installed and maintained in accordance with these instructions. Dolphin Solutions will replace or repair (as appropriate) free of charge any product with a proven manufacturing defect if reported within the warranty period.

Dolphin Solutions Ltd reserves the right to amend the design or dimensions without formal notice.

It is imperative that suitable fixings for the wall installation are used

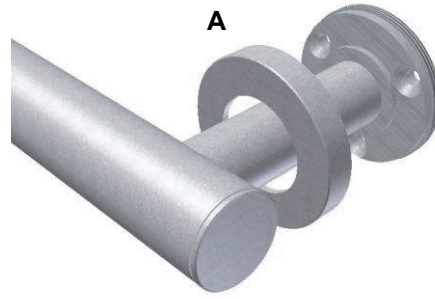

Fixing holes  $\text{Ø}6.2$   
countersunk to  $\text{Ø}12.2$